

# CREATE

## MENTORING PROGRAM

*To educate and inspire students to pursue career pathways that create the built environment.*

### 2023 Project Problem Statement

Issued: August 24, 2023

#### Introduction:

Event venues come in many different forms, and should be able to adapt to accommodate various spatial needs for a community. They are often thought of as the heart of a community where all stakeholders can come together. Below are a few examples of some community event spaces.

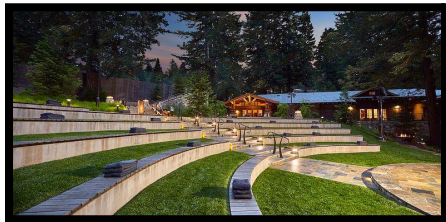

The CREATE Advisory Board invites proposals for the creation of a community events space made up of various buildings across an entire site. The project as a whole must fill a critical need in your community today (research will be required!) while meeting the following parameters:

- Your project must include a minimum of two (2) structures. (1) structure will be for public use or the main stage, and (1) structure must house restrooms and support spaces as required to support your program. Examples of support spaces may include storage, reception, ticketing, or utility spaces. Your project may choose to have a third structure, the program of which is your team's choice.
- Your project must maintain accessibility for all - this is not a code-driven requirement, but instead needs to inform your layout, access to/from, and placement on the site of all program elements for both public and for staff (if any). Accessibility for all is to focus on ensuring that access is equal and that potential barriers are removed.
- The materials for your project should be chosen based on what fits well in the greater context of the community, and what is available nearby.
- The events center should include all functions necessary to serve their intended purpose. This may include but is not limited to:
  - Music or art events
  - Committee meetings
  - Parties or festivals
  - Historical or cultural events

- o Health/food services
- o Emergency services
- o Recreational events
- o Other community need

**Program Requirements:** All submittals can be uploaded to [www.creatementoring.org/submit](http://www.creatementoring.org/submit).

0.1) All students participating in the CREATE Program **must** register online by **September 22, 2023**, in order for the team to receive points.

0.2) Teams may have a maximum of 10 students per team. If a school has more than 10 students, more than 1 team can participate pending notification to CIEF. Any school that would like more than two teams should submit a request to CIEF for review. Approval may be granted depending on the total number of teams in the competition and availability of space and judges on Presentation Day.

0.3) Complete and return the Parent/Guardian Release Form and the Student Commitment Form by **September 22, 2023**. Forms are to be submitted to the classroom teacher. The classroom teacher will compile the forms into a single document and submit it via the link above.

0.4) **Trades Day – Must be submitted by November 30, 2023.**

- Nevada County: **October 10, 2023**
  - San Joaquin: **October 17, 2023**
  - Chico: **November 7, 2023**
  - Sacramento: **November 16, 2023**
  - For other locations, visit TradesDay.org.
- o Percentage of Student Attendance = 0-10 pts
  - o Online Form & 2-3 Photos of Event. Due November 3<sup>rd</sup> = 0-5 pts

**SCHOOLS UNABLE TO ATTEND A TRADES DAY MUST EITHER SCHEDULE A VIRTUAL OR IN-PERSON FIELD TRIP WITH A SUBCONTRACTOR, OR AN IN-CLASSROOM VISIT WITH A MINIMUM OF TWO HANDS-ON DEMONSTRATIONS. AN ATTENDANCE LIST, ONLINE FORM, AND 2-3 PHOTOS SHOULD BE SUBMITTED ON THIS EXPERIENCE IN ORDER TO RECEIVE POINTS IN PLACE OF TRADES DAY.**

0.5) Requests for Information (RFI's) are optional.

- RFI's submitted by **October 6, 2023**, no later than 5 pm will receive a response by **October 13, 2023**.

- RFI's submitted by **November 10, 2023** no later than 5 pm will receive a response by **November 17, 2023**.
- Submissions may be made online using the RFI link located at **[www.creatementoring.org/submit](http://www.creatementoring.org/submit)**.

0.6) Presentation Day: **December 11, 2023** (presentation slides due **November 30, 2023**, no later than 5 pm).

**Deliverable Requirements: (Point totals are as indicated. Where no point total is given, the deliverable is considered pass/fail)**

**Deliverable 1 - Due **10/13/23****

1.1) Needs Assessment (300-500 words) = 0-5 pts

- What is the objective of your project? Who are the end users and what need(s) are you fulfilling in your community? What components do your structures or site elements require to effectively serve the community? Examples of needs include:
  - Seating - a minimum of **250** seats should be provided
  - Shade
  - Restroom access
  - Parking or lack thereof (less parking may encourage a more sustainable community)
- Provide two (2) sources from your research for why this project fulfills a need in your community. This is specific to your community/area and can be survey data, proximity data (the next closest option is \_\_\_ away), statements/quotes from community members, etc. that provide evidence of the existing need.
- Describe the basic function of each of your structures and major site elements.
- Find a precedent of a similar event venue that serves a similar purpose. Analyze why this precedent is important.
- Describe what material(s) you will incorporate into your project. Why did you choose those materials? How do they respond to the context of the community? Projects that use only materials from the following surrounding radii (see appendix B) will receive the following bonus points:
  - Within 100 mile radius = 10 pts
  - Within 500 mile radius = 5 pts
  - Outside 500 mile radius = 0 pts

## 1.2) Diagrams/Hand Sketches = 0-10 pts

- Provide a circulation diagram showing pedestrian and vehicular access, the location of your structures and major site elements, and access to them. Include a legend for each and notations for specific access needs, including and not limited to public, staff, parking or stopping spaces (car, bike, rideshare, etc), stage, lighting/equipment, gathering areas (if part of your program), trash, etc.
- Minimum 1 site plan sketch required per student. These sketches should be submitted as a compiled, single file.

## 1.3) Create a media post about your project concept and tag the Construction Industry Education Foundation = 1pt

- All seniors and scholarship applicants are encouraged to follow the CIEF LinkedIn page ([linkedin.com/company/ciefoundation](https://www.linkedin.com/company/ciefoundation))

## **Deliverable 2 - Due November 11/9/23**

### 2.1) 50% (“half complete”) Construction Document Project Site Plan = 0-10 pts

- Using the given site plan (see appendix C), which is assumed to be in your community, develop an architectural site plan. This drawing should respond to and incorporate the needs assessment submitted for Deliverable #1. All spaces should be identified along with anticipated major equipment, fixtures, and site features.
- Only one site plan should be submitted per team.

### 2.2) Selection of Engineering Component = 0-4 pts

- List choice of an engineering concept to design (structural, mechanical, electrical, civil, stormwater or environmental, etc.).
- List the name, discipline, and email of the mentor (see appendix D for contact list) who will assist with the engineering component.
- Research and give a minimum of two (2) examples of what the final submission of your engineering component will look like.
  - Examples include single line electrical diagram, structural framing plan, plumbing plan, bioswale plan, etc.
  - Examples should not include just a product cut sheet or photo, but be a diagram of a system and how it works together.

### 2.3) Construction Schedule = 0-10 pts

- Using the site plan your team has created, develop a construction schedule. This should include demolition, phasing, access, etc., while taking into account the limitations of certain months of the year (i.e. flooding). See sample schedule (appendix E).

#### 2.4) Field Trip & 2-3 photos = 0-5 pts

- Submit field trip photos online using the submission link.

#### 2.5) Trades Component Idea = 0-5 pts

- *Describe* the choice of what will be built as the to-scale Trade Component Physical Model (woodwork, masonry, wiring, drainage, etc.).
- List the name, discipline, and email of the mentor (see appendix D for contact list), who will assist with the trades component.

### Deliverable 3 - Due **11/30/23**

#### 3.1) Electronic Copy of Slide Presentation must include:

- Team Concept, Research, and Reasoning = 0-5 pts
- Completed (100%) Construction Document Project Site Plan with annotations = 0-10 pts
- Final submission of your Engineering Component (i.e. single line diagram, structural framing plan, or plumbing plan for your specific project) = 0-10 pts
- Construction Schedule = 0-10 pts
- A photo of your Trades Component Physical Model = 0-5 pts
- Minimum of three (3) 3D Rendering or Images to include the overall 3D site, an elevation of the primary stage space, and the user's choice. All views must clearly be labeled in your presentation (i.e. "3D view from southwest") = 0-10 pts

#### 3.2) Team video = 0-10 pts

- Create a video of either:
  - a promo video of your community event space, OR
  - a mentor-recruitment pitch for the CREATE program.
- All videos should be 60-90 seconds.
- Team video will be played during your presentation. Please be sure to account for the length of your video during your presentation time.
- Team videos will also be played during industry lunch on Competition Day.
- All team members must be shown or have a role in the production of the video.

#### 3.3) Promo flyer = 10 bonus pts

- Create a 8.5x11 flyer for your community event space
- Give examples of the types of events
- Add a graphic and/or logo for your event space

### Competition Day - 12/11/23

#### 4.1) Presentation (10-12 min) = 0-10 pts

- Discuss all components in the slide presentation & anything else essential to the project.
- Allot time in your presentation to play team video for judges.
- All team members present should speak in the presentation.

#### 4.2) Physical Mock-Up of Trades Component= 0-10 pts

- Bring the to-scale model of the Physical Model of the Trades Component to the presentation. Examples may include a wall section, a plumbing fitting, bioswale assembly, flooring section, or any other component of the buildings or site. Make sure to reference the model during your presentation.

**Total Points = 145**

For questions on the CREATE Mentoring Program, outside of RFIs, please contact:  
Viviana Castro-Martinez | Program Coordinator | vcastro-martinez@cie.foundation | 916.465.8348

---

Appendix A - Point Recap Table

Appendix B - Radii Example Map

Appendix C - Given Site Plan (in PDF, Revit, and Sketchup)

Appendix D - Mentor Contact List

Appendix E - Sample Construction Schedule

CREATE Mentoring is a program of the Construction Industry Education Foundation.  
5370 Elvas Avenue, Sacramento, CA 95819 | 916.465.8346 | [www.cie.foundation](http://www.cie.foundation)